

The background of the image is a reproduction of the painting 'The Amorous Concert' by Jean-Baptiste Pater. It depicts a group of young women in 17th-century French attire. One woman in a white dress is seated and playing a lute, while others are gathered around her, some looking at the instrument and others in conversation. The scene is set in an interior with a large, patterned rug and a basket of flowers in the foreground.

# CORPORATE & PRIVATE EVENTS

W <sup>T H E</sup> WALLACE  
COLLECTION

# CONTENTS

Receptions & Large Dinners	4
Small Dinners	7
Private Tours	12
Prices	13
Suppliers	15
Contact	16

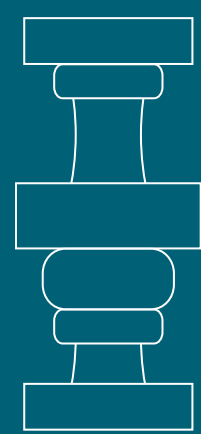



© CHARLOTTE FIELDING

# A UNIQUE COLLECTION IN THE HEART OF LONDON

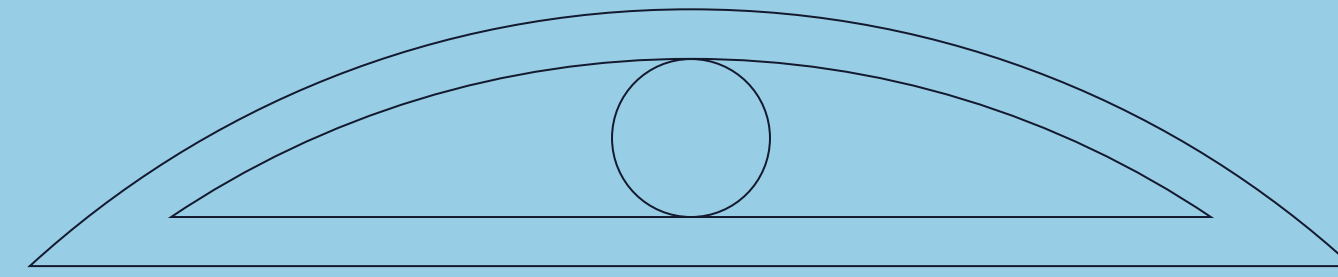

Situated in the heart of London, Hertford House is home to one of the world's finest collections of French eighteenth-century Old Master paintings and decorative arts.

The Collection was formed over five generations of the Hertford family before being given to the Nation by Lady Wallace in 1897. Best known for its paintings by Boucher, Fragonard and Watteau, the museum also boasts outstanding works of porcelain, furniture and an impressive array of arms and armour.

The Wallace Collection offers a range of versatile galleries and spaces for celebrations and special events. To make the most of this unique Collection, private views and guided tours can be arranged. From intimate dinners to large receptions, the Events Department delivers a tailored service, to ensure the highest standards are upheld.

Suppliers have been carefully selected to provide everything you could need from catering and flowers, to lighting and entertainment.

# THE DRAWING ROOM SUITE

1st Floor

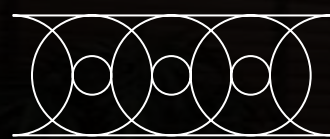

This suite of five interconnected galleries provides a relaxed and intimate space. It is beautifully decorated with furniture, sculpture and paintings, including one of the highlights of the Collection, Fragonard's *The Swing*.

**Suitable for:**  
Pre-dinner and stand-alone receptions

**Capacity:**  
150





1st Floor

# THE GREAT GALLERY

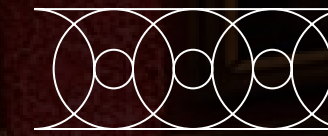

Hailed as 'the greatest picture gallery in Europe', the Great Gallery showcases some of the world's most celebrated Old Master paintings and houses our most iconic pieces, such as Frans Hals' *The Laughing Cavalier* and works by Titian, Rubens and Velázquez.

**Suitable for:**  
Receptions and dinners

**Capacity:**  
Drinks receptions: 250  
Dinners: 160



# THE COURTYARD

Ground  
Floor



Once the sculpture gardens of Sir Richard and Lady Wallace, the Courtyard is at the heart of Hertford House. Its glazed roof makes this space perfect for gala events, product launches and fashion shows year-round. Versatility is the great strength of the Courtyard, where food stations, dance floors, staging and high-production events are all welcome. Additional time can be added to a Courtyard dinner or reception.

**Suitable for:**

Breakfasts, receptions and dinners

**Capacity:**

Breakfasts: 100 standing, 40 seated

Drinks reception: 300

Dinners: 160

Dinner dance: 140









1st Floor

# THE WEST ROOM



This gallery houses paintings by the masters of eighteenth-century British portraiture, Gainsborough and Reynolds. It provides a striking and unique setting for intimate dinners.

**Suitable for:**  
Dinners

**Capacity:**  
12

# THE VENETIAN ROOM

1st Floor

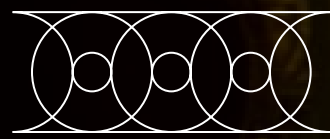

Showcasing the museum's exceptional group of Venetian views by Canaletto and Guardi, this gallery provides a charming setting for dinner.

**Suitable for:**  
Dinners

**Capacity:**  
24





Ground  
Floor

# THE BACK STATE ROOM



The room is a tribute to the patronage of King Louis XV of France and his mistress Madame de Pompadour. This gallery features some of the finest examples of Rococo art in the Collection, making it a striking setting for small dinners.

**Suitable for:**  
Dinners

**Capacity:**  
30

# THE DINING ROOM

Ground  
Floor



This is a light and airy space with views out onto the glazed Courtyard through large windows and French doors. Situated in the original dining room of Sir Richard Wallace's home, its silk lined walls and marble portraiture make it perfect for elegant dinners.

**Suitable for:**  
Dinners

**Capacity:**  
40





1st Floor

# THE DUTCH GALLERIES

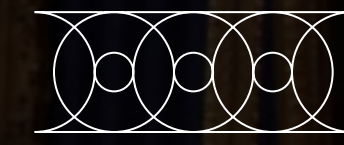

These galleries are hung with deep blue silk and with the museum's collection of Dutch Master paintings, including works by Rembrandt and his followers.

**Suitable for:**  
Dinners

**Capacity:**  
30 or 50 across two adjoining rooms

# PRIVATE TOURS

Exclusive private tours hosted by the museum's experienced Guide Lecturers are available between 09.00 and 10.00, before the museum opens to the public. The maximum number of guests per tour group is 25. Larger groups of up to 100 will be split and additional fees will apply.\*

Guide Lecturers are available to book as part of an evening event, they can give formal tours or be on hand.

\* For groups above 25 there will be an additional fee of £250 + VAT per Guide Lecturer.

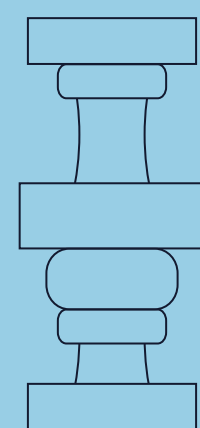

# PRICE LIST

Valid for events taking place  
from April 2024

## Evening

Event Type	Area	Maximum Capacity	Price
Receptions 18:30 - 21:30	Drawing Room Suite	150	£9,000
	Courtyard*	300	£10,000
	Great Gallery	250	£14,000
Dinners 18:30 - 23:00	Courtyard*	160	£15,000
	Great Gallery	160	£18,000
	West Room	12	£10,000
	Venetian Room	24	£10,000
	Back State Room*	30	£10,000
	Dining Room*	40	£10,000
	Dutch Galleries	50	£11,000

### The following elements can be added on to your event to enhance your guests' experience:

Private Views	Ground Floor Galleries	£1,500
	Armouries	£2,000
	Drawing Room Suite	£2,000
	Temporary Exhibition	£3,000
	Great Gallery	£4,000
Guide Lecturers	On hand or providing tours	£250

## Morning

Event Type	Area	Maximum Capacity	Price
Breakfast 08:00 - 09:30	Courtyard	100 Standing	£2,500
		40 Seated	
Private Tour 09:00 - 10:00	Highlights tour	25	£1,500
	Temporary Exhibition	25	£2,000

\* Extra time can be arranged in advance at a cost of £2,000 + VAT per hour until midnight

All prices quoted are subject to VAT

Hire fee on a Friday, Saturday or Sunday night is a minimum of £14,000 + VAT

Service ends 30 minutes before the close of event

Please note Corporate Members enjoy discounted and complimentary hire of the Wallace Collection, as well as exclusive access to our exhibitions and curators.

# MAP

## Ground Floor

- The Courtyard
- The Back State Room
- The Dining Room

## 1st Floor

- The Drawing Room Suite
- The Great Gallery
- The West Room
- The Venetian Room
- The Dutch Galleries

## Ground Floor

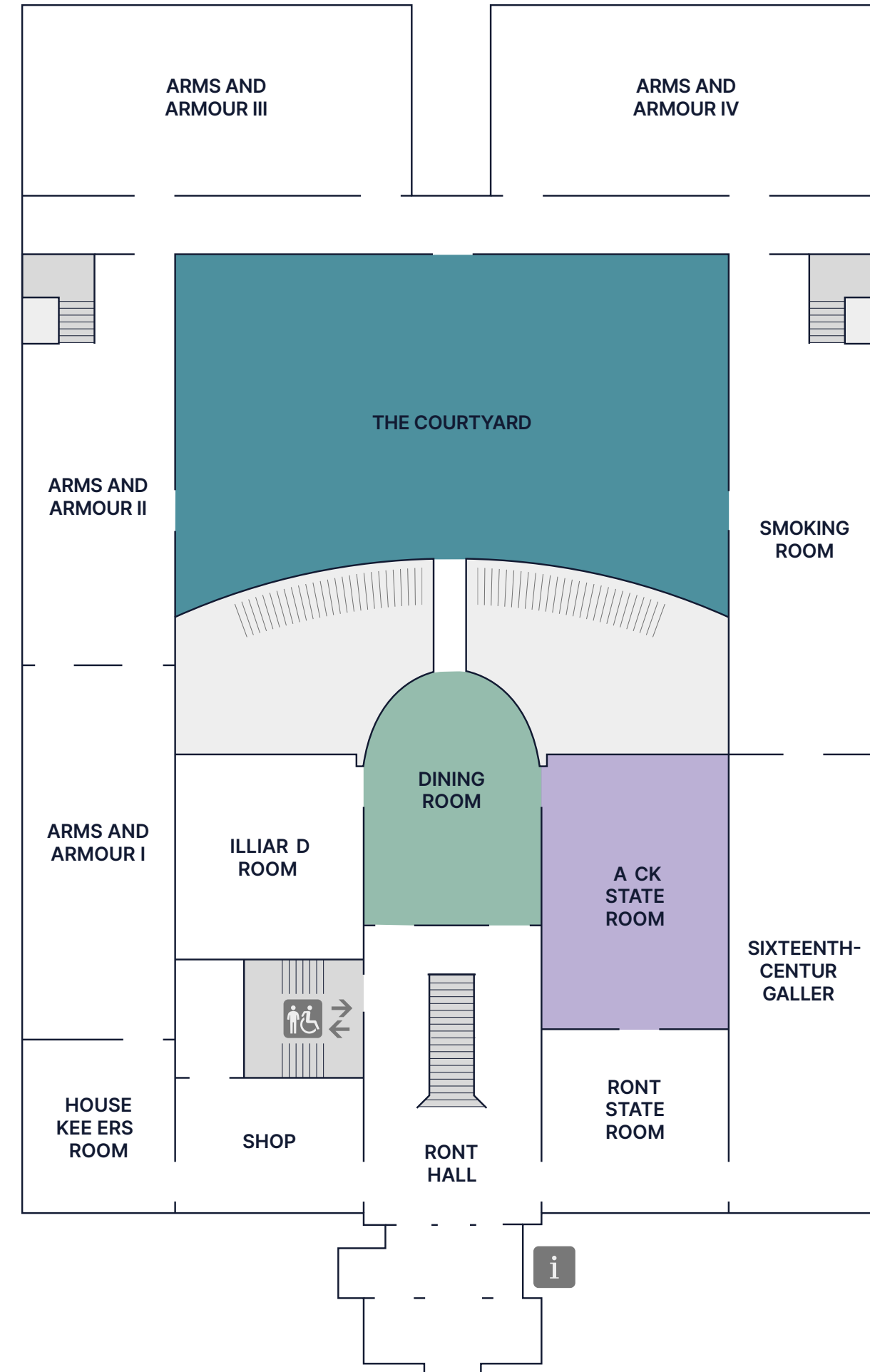

## 1st Floor

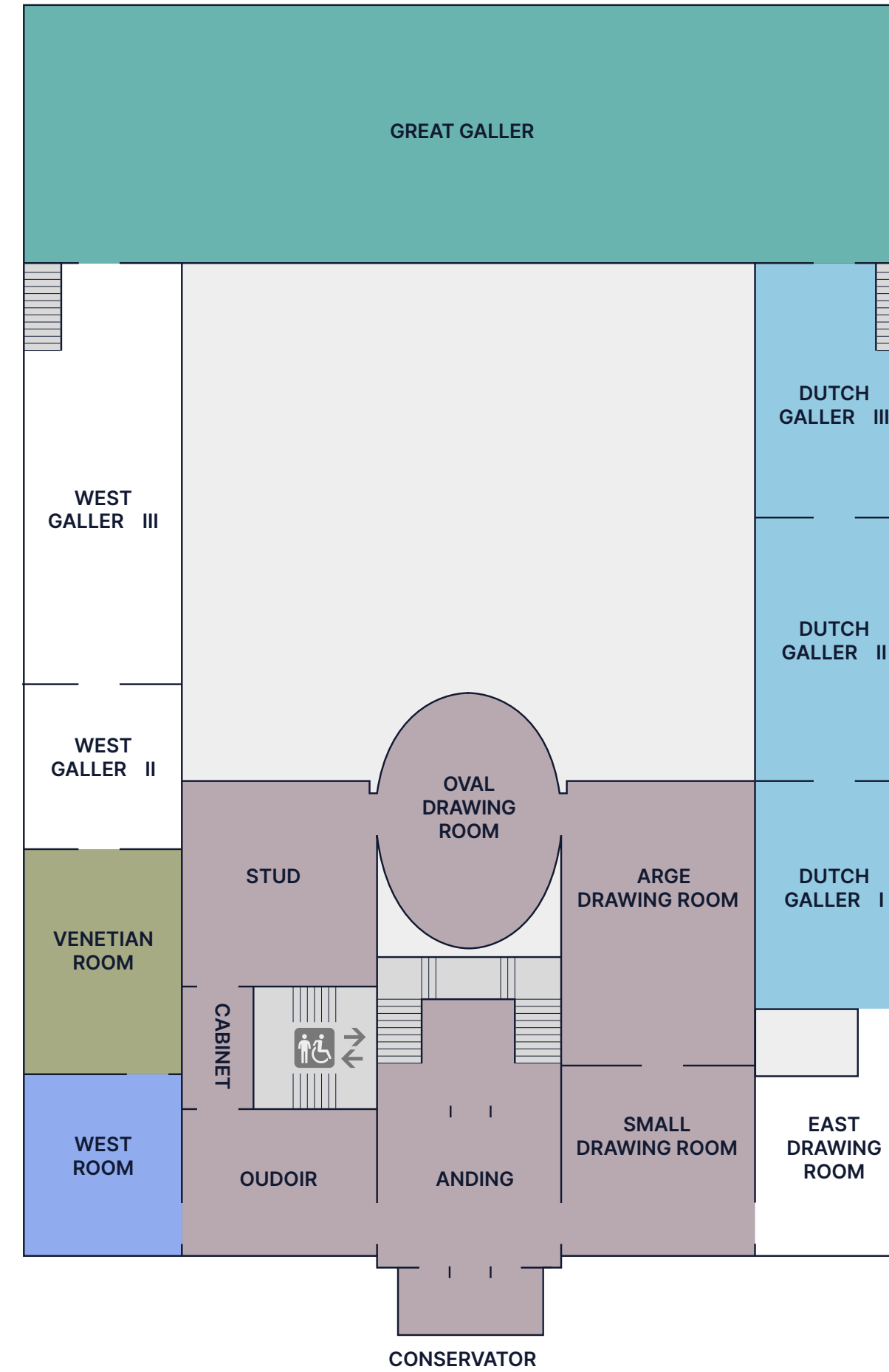

## Lower Ground

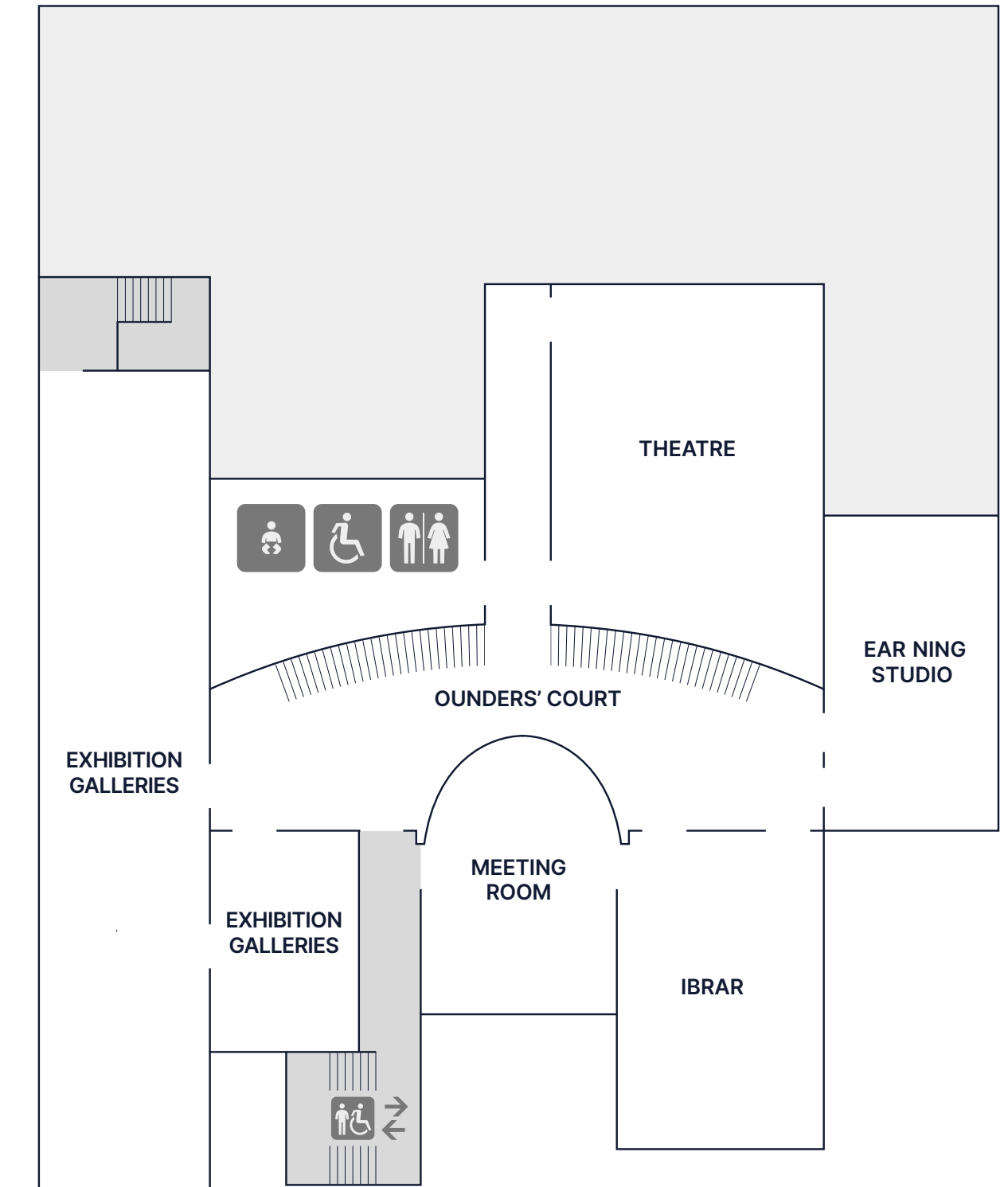



# SUPPLIERS

The Wallace Collection works with an accredited list of suppliers. This ensures that your event will be delivered to the highest standards.

## Caterers

---

### The Admirable Crichton

T: 020 7326 3800  
parties@admirable-crichton.co.uk  
admirable-crichton.co.uk

### Alison Price & Company Ltd

T: 020 7840 7640  
enquiries@alisonprice.co.uk  
alisonprice.co.uk

### Blue Strawberry

T: 020 7733 3151  
hello@bluestrawberry.co.uk  
bluestrawberry.co.uk

### Bubble

T: 020 7703 2653  
info@bubblefood.com  
bubblefood.com

### By Word of Mouth

T: 020 8871 9566  
events@bywordofmouth.co.uk  
bywordofmouth.co.uk

### Caper & Berry

T: 0207 940 3761  
events@caperandberry.co.uk  
caperandberry.co.uk

### Heritage Portfolio

T: 07551 822 769  
events@heritageportfolio.co.uk  
heritageportfolio.co.uk

### Rocket Food Ltd

T: 020 7622 2320  
parties@rocketfood.com  
rocketfood.com

### Social Pantry

T: 020 8871 1949  
enquiries@socialpantry.co.uk  
socialpantry.co.uk

### Zafferano

T: 020 8905 9120  
info@zafferano.co.uk  
zafferano.co.uk

## Specialty Kosher Catering

---

### Tony Page

T: 020 8830 4000  
hello@tonypage.com  
tonypage.com

## Specialty Asian Catering

---

### Laguna

T: 020 8579 9992  
info@lagunarestaurant.com  
lagunarestaurant.com/event-catering

## Production Specialists

---

### Bespoke Events London

T: 020 8961 1510  
studio@bespoke-london.co.uk  
bespoke-london.co.uk

### DeltaLive

T: 020 8339 3800  
enquiries@deltalive.com  
deltalive.com

### Event Concept

T: 020 7740 3988  
info@eventconcept.co.uk  
eventconcept.co.uk

### Focus Productions

T: 020 8542 9221  
info@focus productions  
focus productions

### Ingenius Productions

T: 020 8971 7888  
mail@ingeniusuk.com  
ingeniusuk.com

### Wise Productions

T: 020 8991 6922  
events@wiseproductions.co.uk  
wiseproductions.co.uk

## Florists

---

### Flower & Press

T: 07760 491 234  
info@flowerandpress.com  
flowerandpress.com

### Gail Smith Flowers

T: 020 7697 9284  
info@gailsmith.co.uk  
gailsmith.co.uk

### Lavender Green

T: 020 7127 5303  
info@lavendergreen.co.uk  
lavendergreen.co.uk

### Pinstripes & Peonies

T: 020 7720 1245  
flowers@pinstripesandpeonies.com  
pinstripesandpeonies.com

### Simon J Lycett Limited

T: 020 7277 3322  
enquiries@simonlycett.co.uk  
simonlycett.co.uk

### Veevers Carter

T: 020 7237 8800  
info@veeverscarter.com  
veeverscarter.com

### Wild About

T: 020 3794 7487  
leanne@wildabout.co.uk  
wildabout.co.uk

## Musicians & Entertainment

---

### Euphonica

T: 020 3397 9018  
hello@euphonica.com  
euphonica.com

### Prelude

T: 020 8660 6647  
sales@preludeentertainment.co.uk  
preludeentertainment.co.uk

### Sternberg Clarke

T: 020 8877 1102  
sales@sternbergclarke.co.uk  
sternbergclarke.co.uk

# CONTACT

Whether your needs are for corporate entertaining, product launches or private parties our dedicated team are here to help you plan the perfect occasion.

The Events Department  
The Wallace Collection  
Hertford House  
Manchester Square  
London, W1U 3BN  
020 7563 9507 / 545 / 564 / 546

**Email:** [events@wallacecollection.org](mailto:events@wallacecollection.org)

**Website:** [wallacecollection.org/venuehire](http://wallacecollection.org/venuehire)

**Instagram:** [@wallacecollection\\_events](https://www.instagram.com/wallacecollection_events)

[Click here to sign up to our quarterly newsletter for the latest venue hire updates.](#)

